

GOLDEN SELECT™ LAMINATE FLOOR INSTALLATION GUIDE

SHADE: Montana Oak
STYLE: 77LAM0571C

IMPORTANT: BEGIN INSTALLATION AT THE TOP RIGHT HAND CORNER OF THE ROOM. PLANKS ARE INSTALLED FROM THE RIGHT TO THE LEFT-HAND SIDE OF THE ROOM.

NOTE: It is important to read the instructions before installation.

TOOLS:

Hand or power saw (fine-toothed blade), chalk line/string, spacers, set square, vapor barrier: min. 0.15 mm /0.006" (for installation on concrete and radiant heat floors), pencil, tape measure, tapping block, rubber mallet, pull bar, utility knife.

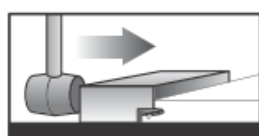

Tapping block



Pull bar

NOTE: Safety glasses and gloves should be worn at all times.

SUBFLOOR

The ideal conditions are 40%-60% relative humidity. If the rooms have higher levels of humidity, or if the home has a crawlspace and/or cellar is considered a cottage, please consult a specialist in your area and/or the construction norms.

A) Concrete Floors

- The surface must be absolutely level, dry and clean. Differences in the floor level of more than 6.25 mm per 1.52 m (1/4" per 5 ft.) must be leveled.
- Use a vapor barrier at least 0.15 mm (0.006") thick. Edges should overlap by 200 mm (8").
- Ensure that 25 mm (1") of the vapor barrier is up on the walls.
- Lay down flooring.

B) Wood and other hard surfaces

- The surface must be dry, clean, smooth and level. Slopes steeper than 6.25 mm per 1.52 m (1/4" per 5 ft.) must be leveled.
- Lay down flooring.

C) Carpet and underpadding

- Remove both before laying down the floor, and proceed as outlined in A or B.

D) Vinyl floor surfaces

- Lay down flooring. (If the vinyl is on top of concrete, a moisture barrier must be placed on top of the vinyl before installing the floor).

E) Radiant heat floors

- Follow the installation instructions provided by the radiant heat manufacturer.
- New concrete subfloors must be cured with no heat transfer for 60 days.
- The radiant heating must be operational for two weeks prior to installing the laminate flooring, and the temperature must be maintained between 18-22°C (65-72°F).
- Keep the temperature below 27°C (80°F) at all times.
- Slight gaps may occur between laminate planks installed over radiant heating and will not be covered by the warranty.

PREPARATION

- 1) Leave closed packages in a horizontal position in the room for 48 hours prior to installing.
- 2) Subfloor needs to be prepared (as above).
- 3) There must be at least 12.5 mm (1/2") between the surface of the floor and the bottom of electrical baseboard heater to allow heat to circulate.
- 4) Verify door and frame clearances and make required adjustments before laying down the floor. Cut the door moulding with a saw to allow planks to slide underneath. (See figure A.)
- 5) Carefully remove existing baseboards.
- 6) Decide in which direction the planks should be laid. As a rule, the floor planks should be laid perpendicular to the wall that has a window in it. To make the room appear larger, it may be preferable to lay down the floor planks parallel to the longest wall.
- 7) Before installing, check planks for defects such as chips and colour or sheen differences under good light conditions. Check that the channel is clean and free of debris. Damaged planks must be replaced before laying down the floor.
- 8) A minimum expansion area is required around the perimeter of the room as well as any fixed object (door frame, fireplace mantle, etc.): 10 mm (3/8") for rooms 7.6 m (25 ft.) long or wide, 15 mm (5/8") for rooms greater than 7.6 m (25 ft.).

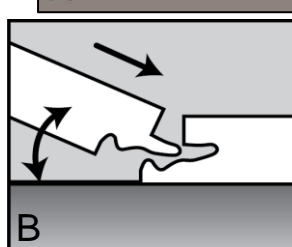
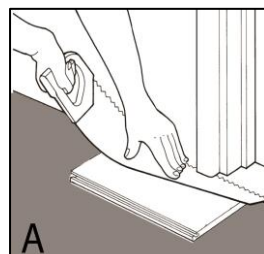

INSTALLATION

THIS PRODUCT IS PRIMARILY MADE OF WOOD MATERIAL AND NEEDS ROOM TO EXPAND AND CONTRACT. DO NOT ATTACH THE FLOOR TO ANY SURFACE. ALWAYS ALLOW AN EXPANSION GAP AT THE PERIMETER AND AROUND ALL OBSTACLES.

1. Installation method: the planks click together at a 45° angle on the length side (see figure B). Note that a tapping block and mallet may be used for a tighter fit along the lengths of planks. Do not use excessive force, as this may damage the tongue and/or groove. Connecting the short ends together **must** be done using a tapping block and mallet – tapping the tongue into the groove (see figure C). When installing the last plank in a row, it may be necessary to use a pull bar. Place the pull bar between the wall and the laminate and gently tap on the lip on top (see figure D).
2. Measure the room to establish its squareness and the width of the last row. If the width of the last row is less than 50 mm (2"), not including the bottom lip of the groove, the first row will have to be cut accordingly. The tongue on the first row of planks and the bottom lip of the groove side on the last row of the planks should also be removed (see figure E). Use T-mouldings if the floor is wider or longer than 10 m (33 ft.)
3. Irregular wall along the first row of planks - scribe the planks to fit the wall and cut.
4. When cutting a plank, if using a portable electric saw (jigsaw), the decorative surface must face up. If using a circular table saw, the decorative surface must face down.
5. **Begin installation on the top right hand corner of the room**, with the tongue side against the starting wall. Always place a 10-15 mm (3/8"-5/8") spacer between the wall or any fixed object (door frame, fireplace mantle, etc.) and the plank on either side of each joint and at the far ends of each plank.
6. The first and last plank in a row must be at least 300 mm (12") long. Measure the first row before installing. To avoid ending the row with a plank of less than 300 mm (12") in length, it may be necessary to cut the first plank. Always remove the groove on the last plank. For the first plank of the second row, use the cut plank left over from the first row provided it is more than 300 mm (12") long. If it is less than 300 mm (12") long, use a new plank, cutting it so it is at least 300 mm (12") away from the joint of the first plank on the first row. Always remove the bottom lip of the groove and the tongue from the ends of the planks against the walls (see figure E).
7. Continue laying down the floor from right to left. For a stronger and more natural looking floor, make sure to stagger the joints in each row by at least 200 mm (8"). Remove the spacers and install mouldings and trims. Never nail the mouldings to the laminate floor.
8. Transition mouldings must be added between every doorway to allow for the natural expansion and contraction of the floor.
9. Do not nail or screw fixtures to the flooring. Laminate is not recommended for kitchens. However, if it is decided to install laminate in a kitchen, do not install kitchen cabinets or islands on top of the laminate flooring. The weight of these can impede the natural expansion and contraction of the floor.

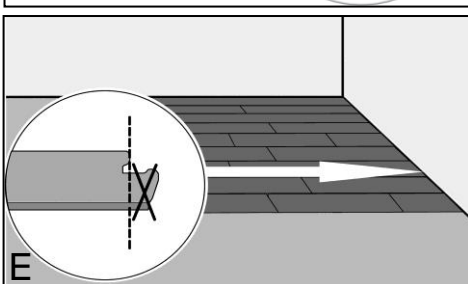
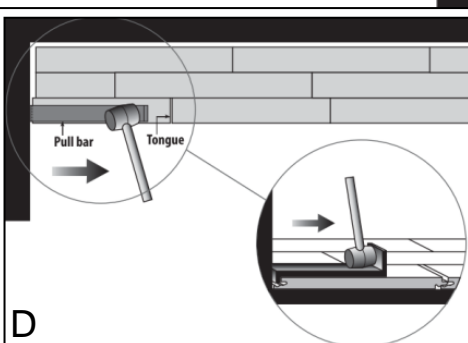
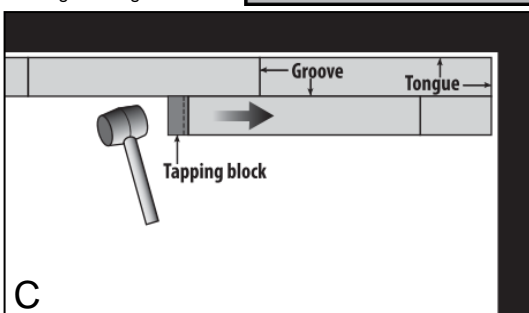

CARE AND MAINTENANCE

- Remove dust and dirt with a broom or vacuum.
- Clean floor using a damp cloth or mop if necessary. Do not wet mop the floor.
- Do not use soap based cleansers or abrasive detergents.
- Wipe up spills immediately.
- Never let water stand on the floor for any length of time.
- Use area rugs in entrances and high traffic areas.
- Use floor protectors under furniture.
- Maintain the humidity level in the installation space between 40% and 60% year round. It may be necessary to use a dehumidifier in periods of high humidity and a humidifier in periods of low humidity.

WARRANTY

Golden Select affirms that the enclosed flooring is warranted for residential use to the original purchaser for a period of 30 years. The stipulations of this warranty are as follows:

- The flooring will be free of manufacturing defects.
- The flooring surface will not wear through under normal usage.
- The flooring will not stain.
- The flooring will not fade due to exposure to lighting or UV rays.

The following conditions apply to the warranty and may void the warranty if not followed correctly. The owner must follow the care and maintenance guidelines.

- The flooring must be installed according to the instructions provided.
- If filing a warranty claim it must be submitted within 30 days of the discovery of the damage.
- Surface wear must be evident and visible, measuring at least 13 cm² (2 square inches).
- Proof of purchase, such as a bill of sale is mandatory when requesting warranty service.
- The manufacturer reserves the right to designate a representative to inspect the floor in question and remove samples for analysis.
- Removing flooring prior to contacting Golden Select Claim Department voids the warranty.
- The warranty includes the replacement material, and excludes labour cost.
- The warranty only applies to flooring installed in appropriate indoor, residential environments.
- Upon approval of a warranty claim, Golden Select will provide the claimant with instructions on how to proceed to have the flooring repaired or replaced. The claimant has 90 days to comply with the instructions. If the claimant fails to do so within 90 days, all rights under the limited warranty are waived.

WARRANTY EXCLUSIONS

- Damage due to improper installation, care, cleaning, or maintenance.
- Damage caused by severe impact, scratching, or cutting, fire, water damage, alterations, or any other wear or damage caused by acts of God.
- Although Golden Select laminate flooring has treated edges to improve moisture resistance, it is not waterproof. Damage caused by water or any other liquids, such as swelling and bubbling, is not covered by the warranty.
- Flooring installed in bathrooms or laundry rooms are not covered by the warranty.
- Slight gaps may occur between laminate planks installed over radiant heating and will not be covered by the warranty.
- Peeling and wear in beveled-edged products along the edge of the panels less than 5 mm (3/16") from the edge is not covered by the warranty.
- The limited warranty does not apply to mouldings.
- The warranty applies only to flooring purchased through an authorized dealer.

DISCLAIMER

Golden Select offers no other warranty, expressed or implied. This warranty replaces all other warranties.

FILING A CLAIM

Any claim under the above warranty must be made within 30 days after the issue is detected by contacting Technical Support by email at techsupport@goldenselect.ca or by telephone at (1 800) 234 219. Proof of purchase (indicating the date of purchase) must be presented to file a claim. Golden Select reserves the right to send a representative to inspect the floor and remove samples for analysis. If the claimant fails to give reasonable cooperation to the representative to inspect the flooring and remove samples, Golden Select shall be under no obligation to provide any remedies to the claimant.

***Important to note: The owner/purchaser must inspect for colour, finish and the quality before installation. The manufacturer cannot be held responsible for costs incurred when a floor with visible defects has been installed.**

For questions regarding installation, please contact our Technical Support Department by email at techsupport@goldenselect.ca or by telephone at (1 800) 234 219. To purchase matching mouldings, please contact our Customer Service Department at info@goldenselect.ca or visit www.goldenselect.ca.